

## DATA SHEET

Model No.: GP85AAAHCE

<b>Type</b>	Rechargeable Nickel Metal Hydride Cylindrical Cell
<b>Recycled material content</b>	Rechargeable Nickel Metal Hydride Battery Made with Minimum 10% Recycled materials
<b>Nominal Dimension (with Sleeve)</b>	Diameter = 10.5mm Height = 44.5mm
<b>Applications</b>	Recommended discharge current 85 to 2550mA
<b>Nominal Voltage</b>	1.2V
<b>Capacity</b>	Rated: 850mAh Typical: 900mAh When discharged at 170mA to 1.0V at 20°C
<b>Charging Condition</b>	85mA for 16 hrs at 20°C
<b>Charge Retention</b>	80% of rated capacity after cell storage at 20°C for 12 months When discharged at 170mA to 1.0V at 20°C
<b>Fast Charge</b>	425mA to 850mA (0.5 to 1C) charge termination control recommended control parameters: -ΔV : 0-5mV DT/dt : 0.8°C/min (0.5 to 0.9C) 0.8 - 1°C/min (1C) TCO : 45 - 50°C Timer : 105% nominal input (for ref. only)
<b>Service Life</b>	>500 cycles (IEC61951-2(2017) 7.5.1.2) >200 cycles (IEC61951-2(2017) 7.5.1.4)
<b>Continuous Overcharge</b>	85mA maximum current for 1 year. No conspicuous deformation and/or leakage
<b>Weight</b>	14.5g
<b>Internal Resistance</b>	Average 40mΩ upon fully charged (Max. 60mΩ) at 1000Hz
<b>Max. Charge Voltage</b>	1.5V at 85mA charging
<b>Ambient Temperature Range</b>	Standard Charge: 0 to 45°C Fast Charge: 10 to 45°C Discharge: -20 to 50°C Storage: -20 to 35°C Storage(1week): -20 to 60°C

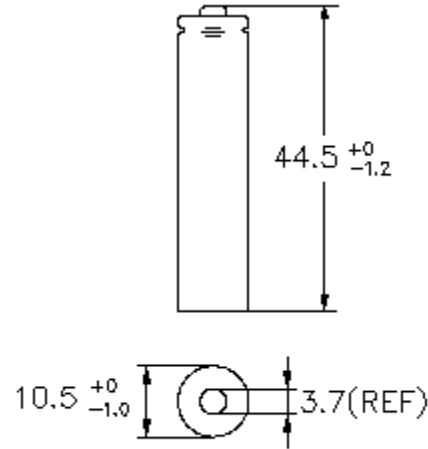

Unit: mm

### Low Rate Discharge

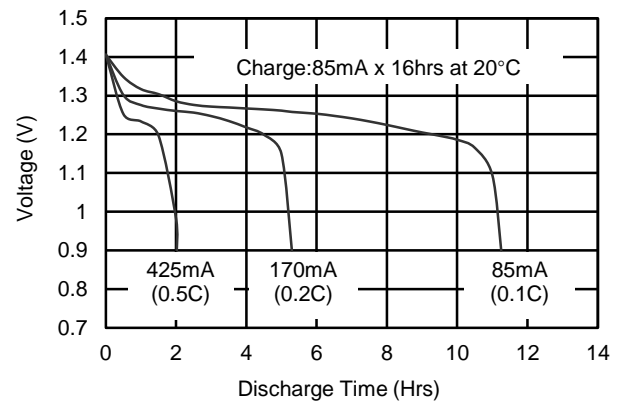

### High Rate Discharge

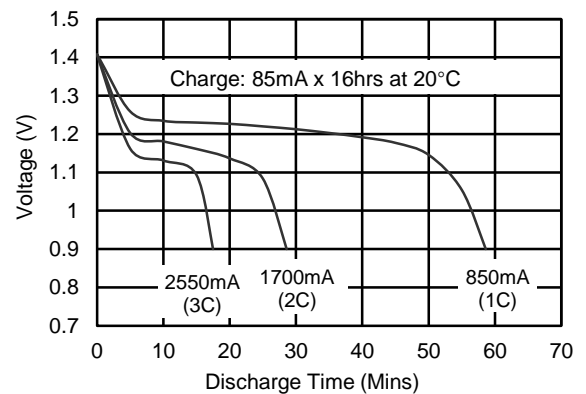

### Fast Charge (Charge Control Required)

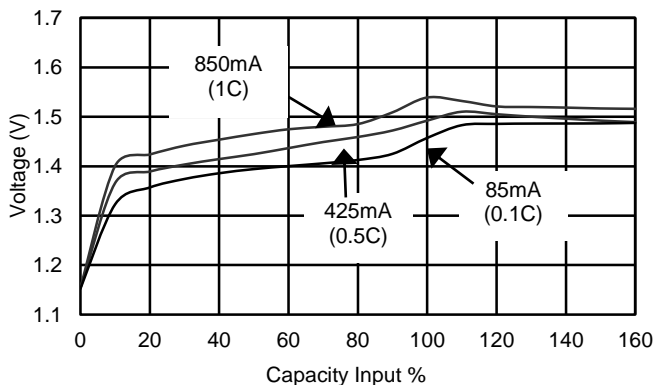

The above information is generally descriptive only and is not intended as guarantee or warranty. Cell and battery specifications are subject to change without notice. All descriptions or warranties are contained solely in specification sheets accompanying outside those described in this document.

TRS1138 rev.02