

## DATA SHEET

<b>Type</b>	Rechargeable Nickel Metal Hydride Cylindrical Cell
<b>Recycled material content</b>	Rechargeable Nickel Metal Hydride Battery Made with Minimum 10% Recycled materials
<b>Nominal Dimension (with Sleeve)</b>	Diameter = 14.5mm Height= 50.5mm
<b>Applications</b>	Recommended discharge current 130 to 3900mA
<b>Nominal Voltage</b>	1.2V
<b>Capacity</b>	Rated: 1300mAh Typical: 1350mAh When discharged at 260mA to 1.0V at 20°C
<b>Charging Condition</b>	130mA for 16 hrs at 20°C
<b>Charge Retention</b>	80% of rated capacity after cell storage at 20°C for 12 months When discharged at 260mA to 1.0V at 20°C
<b>Fast Charge</b>	650mA to 1300mA (0.5 to 1C) charge termination control recommended control parameters: -ΔV : 0-5mV DT/dt : 0.8°C/min (0.5 to 0.9C) 0.8 - 1°C/min (1C) TCO : 45 - 50°C Timer : 105% nominal input (for ref. only)
<b>Service Life</b>	>500 cycles (IEC61951-2(2017)-7.5.1.2) >200 cycles (IEC61951-2(2017)-7.5.1.4)
<b>Continuous Overcharge</b>	130mA maximum current for 1 year. No conspicuous deformation and/or leakage.
<b>Weight</b>	23.0g
<b>Internal Resistance</b>	Average 25mΩ upon fully charged (Max. 35mΩ) at 1000Hz
<b>Max. Charge Voltage</b>	1.5V at 130mA charging
<b>Ambient Temperature Range</b>	Standard Charge: 0 to 45°C Fast charge: 10 to 55°C Discharge: -20 to 50°C Storage: -20 to 35°C Storage(1week): -20 to 60°C

Model No.: GP130AAHCE

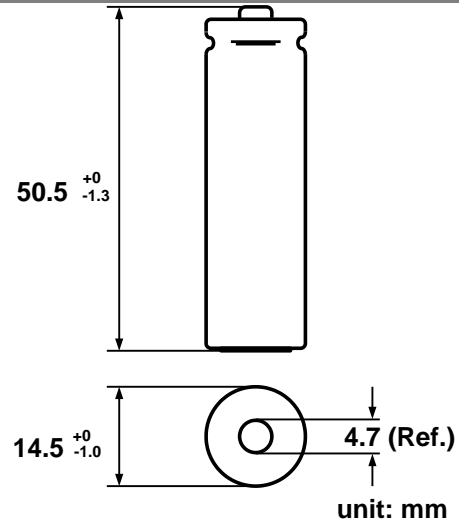

### Low Rate Discharge

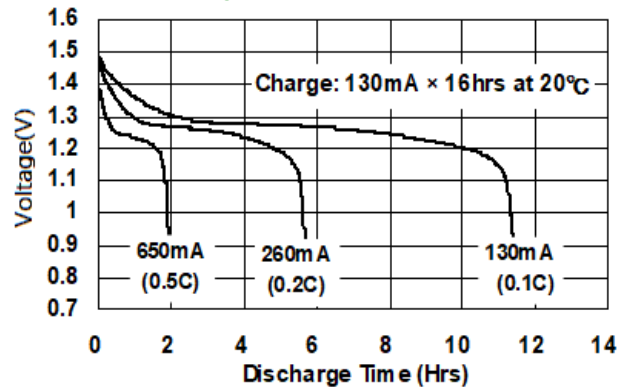

### High Rated Discharge

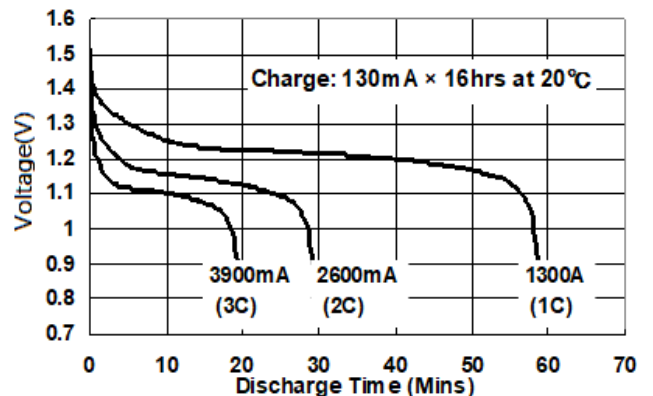

### Fast Charge (Charge control Required)

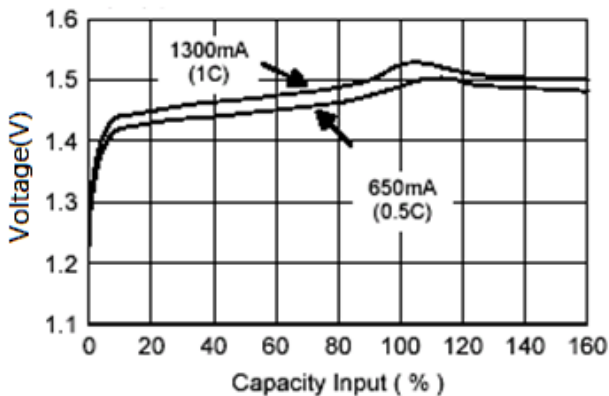

The above information is generally descriptive only and is not intended as guarantee or warranty. Cell and battery specifications are subject to change without notice. All descriptions or warranties are contained solely in specification sheets accompanying outside those described in this document.

MRS6392 rev.02