

DATA SHEET

Model No.: GP100AAHCE

Type	Rechargeable Nickel Metal Hydride Cylindrical Cell
Recycled material content	Rechargeable Nickel Metal Hydride Battery Made with Minimum 10% Recycled materials
Nominal Dimension (with Sleeve)	Diameter = 10.5mm Height = 44.5mm
Applications	Recommended discharge current 95 to 2850mA
Nominal Voltage	1.2V
Capacity	Rated: 950mAh Typical: 990mAh When discharged at 190mA to 1.0V at 20°C
Charging Condition	95mA for 16 hrs at 20°C
Charge Retention	70% of rated capacity after cell storage at 20°C for 6 months, 50% of nominal capacity after cell storage at 20°C for 1 year When discharged at 190mA to 1.0V at 20°C
Fast Charge	475mA to 950mA (0.5 to 1C) charge termination control recommended control parameters: -ΔV : 0-5mV DT/dt : 0.8°C/min (0.5 to 0.9C) 0.8 - 1°C/min (1C) TCO : 45 - 50°C Timer : 105% nominal input (for ref. only)
Service Life	>500 cycles (IEC61951-2(2017) 7.5.1.2) >200 cycles (IEC61951-2(2017) 7.5.1.4)
Continuous Overcharge	95mA maximum current for 1 year. No conspicuous deformation and/or leakage
Weight	15.2g
Internal Resistance	Average 40mΩ upon fully charged (Max. 55mΩ) at 1000Hz
Max. Charge Voltage	1.5V at 95mA charging
Ambient Temperature Range	Standard Charge: 0 to 45°C Fast Charge: 10 to 45°C Discharge: -20 to 50°C Storage: -20 to 35°C Storage(1week): -20 to 60°C

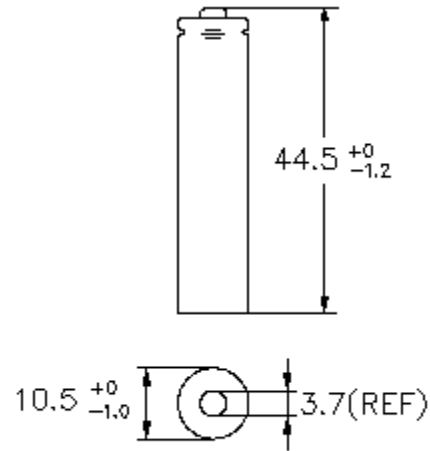

Unit: mm

Low Rate Discharge

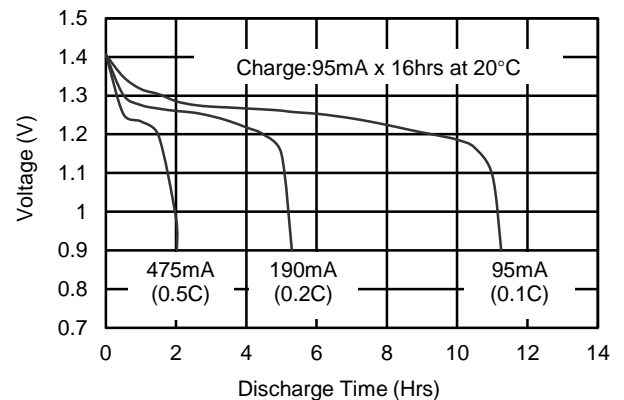

High Rate Discharge

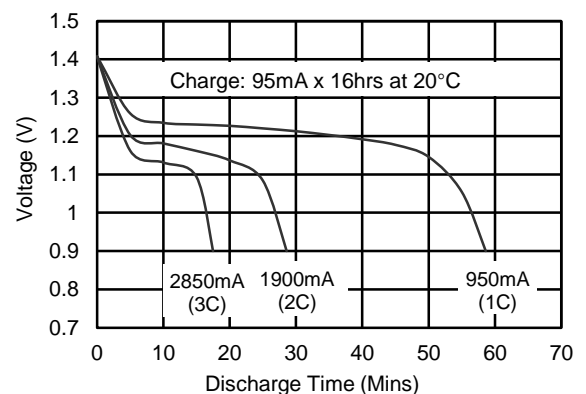

Fast Charge (Charge Control Required)

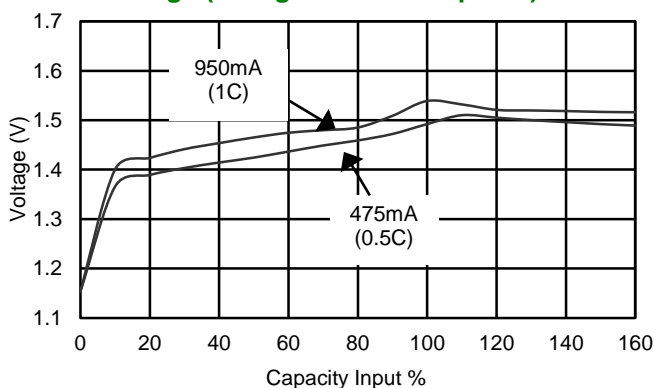

The above information is generally descriptive only and is not intended as guarantee or warranty. Cell and battery specifications are subject to change without notice. All descriptions or warranties are contained solely in specification sheets accompanying outside those described in this document.

TRS1140 rev.02