

**Type Number**..... 6477  
**Designation IEC**.....  
**System**..... Li-Manganese dioxide/  
 Organic Electrolyte  
  
**Nominal Voltage**..... 3 V  
**Typical Capacity C**..... 850 mAh

**Temperature Ranges**                    min            max.  
 Storage ..... -55°C            70°C  
 Discharge..... -30°C            60°C

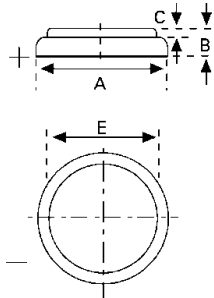

**Dimensions**                                min            max  
 Diameter (A)..... 24,20            24,50  
 Height (B)..... 7,20            7,70  
 Shoulder Diameter (E)..... 22,00

Weight (approx.)..... 10,50 g

<b>Discharge Type</b>	<b>Load</b>	<b>End Voltage</b>	<b>2.0 V</b>
Continuous 24h/d, 7d/w	5600 Ω	Time [h]	1650

**No publication or circulation of data to third parties without consent of VARTA Consumer Batteries**

All Data contained herein is for single cells.  
 For battery applications, performance data may vary from single cell data, depending on specific battery configuration.